

### MOUNTING YOUR BRACKET

Install the light on the handbar, seat post or seat stay by using strap or cable tie.

(Front Light)

(Rear Light)

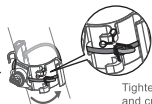

Ø19~Ø32mm

Tighten up the cable tie and cut the extra part of it by using scissors.

### MOUNTING YOUR LIGHT

When the light and bracket is in horizontal condition, install the light on the bracket and twist it in the position of 90° and fasten it.

(Front Light)

(Rear Light)

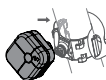
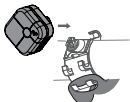

### LIGHT REMOVAL

Twist the light in the direction of right or left into 90° and remove it from bracket.

(Front Light)

(Rear Light)

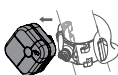
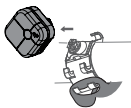

### BATTERY INSTALLATION

Remove the lens by placing a coin in the side slot and twist until the two sides separate.

Install 2 new CR2032 battery into the battery connector one by one, then put the case back.

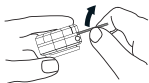

### ARIA SPORT

### MOUNTING YOUR LIGHT

### REMIIND

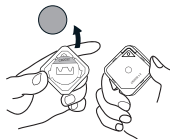
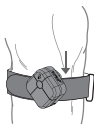
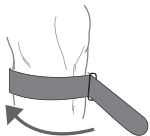

Tighten up the arm band.

Clip the light on the arm band.

Please remove battery insulation sheet before first use

### COMPONENTS

bracket / pad / ring / cable tie x 2

I-220W

I-220R

ARIA SPORT

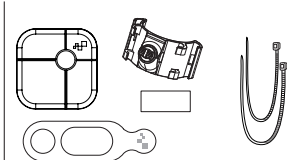
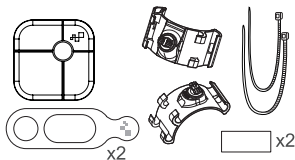

Arm Band



### TO SWITCH MODES

Press the button on the front of the light.

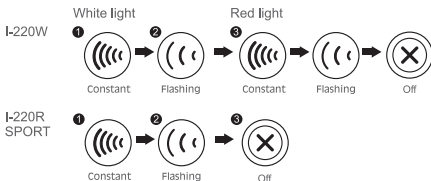
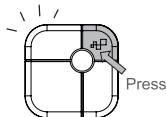

### SPECIFICATIONS

Size:	30 X 30 X 21 mm
Weight:	25g (without battery)
LED:	I-220W 1 White LED and 2 Red LEDs
	I-220R/SPORT 3 Red LEDs
Battery:	CR2032 x 2



### PRODUCT WARRANTY

INFINI offers a Two-year Limited Warranty from the date of original purchase. Products are warranted to be free from manufacturing defects in materials and workmanship under normal use.

Batteries are covered by 90 days warranty(only for rechargeable light ). To obtain warranty service, products should be returned with proof of purchase from an authorized retailer.



A6I220R1612