

MODES

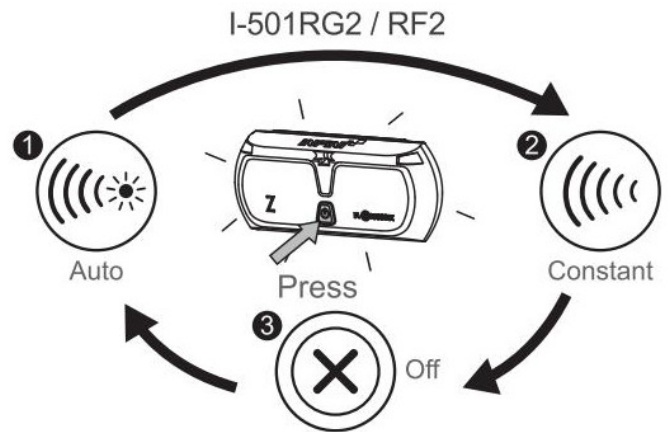

TO SWITCH MODES

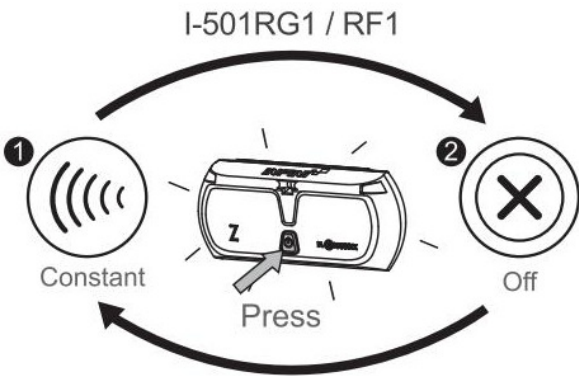
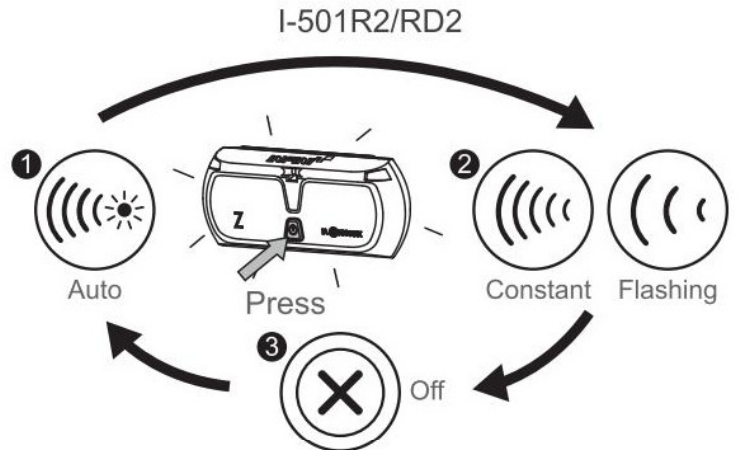
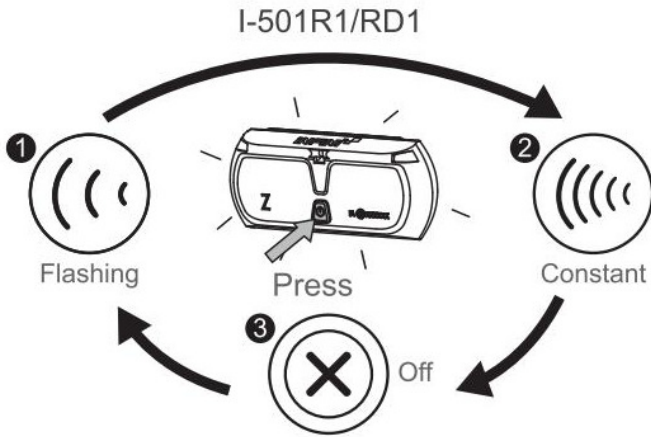
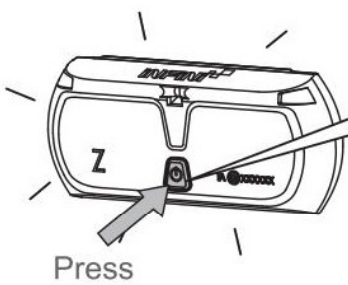

Green Light:

Slow flashing then off - Auto mode
Fast flashing then off - Regular mode
Constant - Low battery indicator
(Please replace the battery once the low battery indicator shows.)

*AUTO: Automatically turn off and turn on with light and motion sensor and keep the light glowing for 4 mins after you stop.

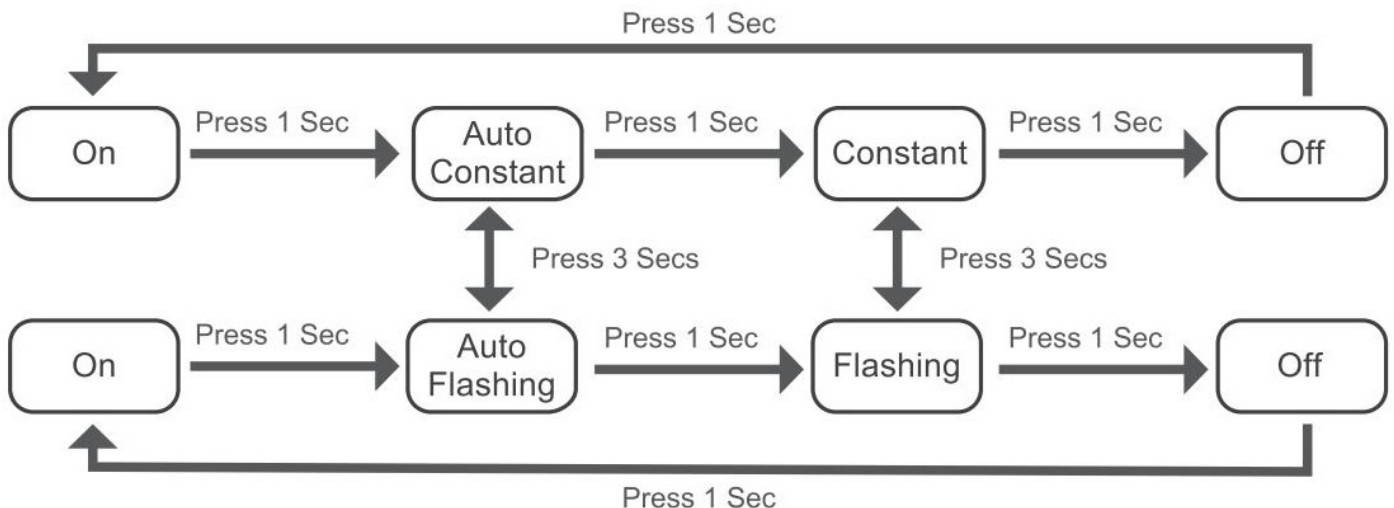

BATTERY INSTALLATION

Remove the lens by placing a coin in the side slot and twist until the two sides separate.

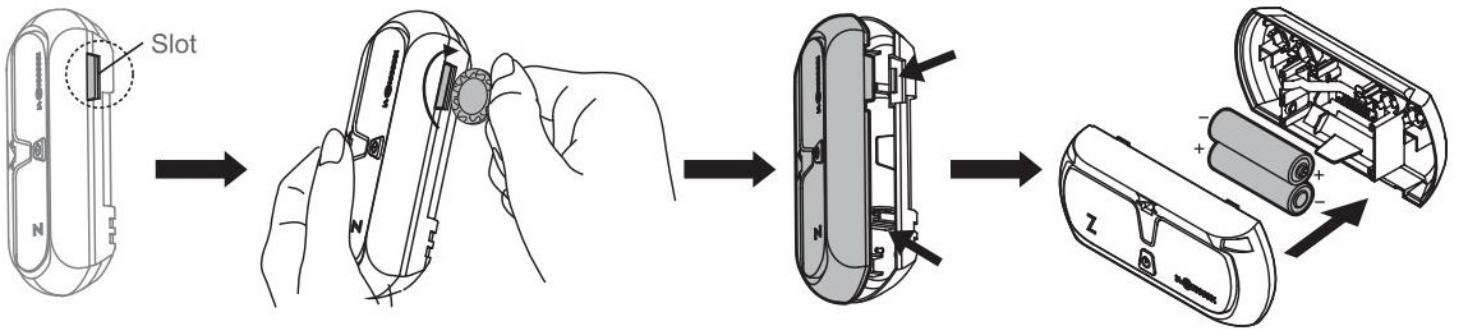

Fasten the tenons on the main unit and the lens then snap the two sides together.



CABLE CONNECTION (I-501M)

1. Mount the light on your bike by using M5x20mm screw (included) and screwing to tighten.
2. Plug cables onto connection without any tools.

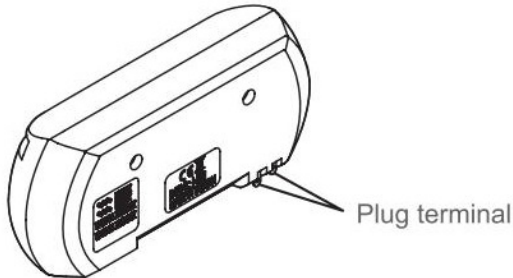

MOUNTING YOUR LIGHT ON CARRIER RACK

The light has two bolts on the back for mounting on your luggage carrier. The bolts can be width adjusted according to the size you need.

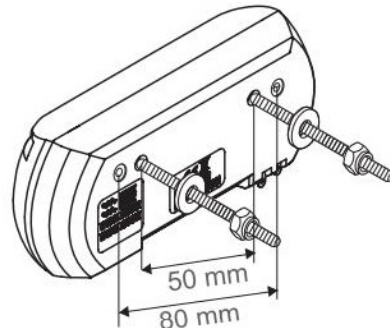

SPECIFICATIONS

0.5 Watt Red LED Carrier Light

I-501R1/RD1: 65 hrs (Flashing) / 40 hrs (Constant)

I-501R2/RD2: Auto / 65 hrs (Flashing) / 40 hrs (Constant)

I-501RG1 / RF1: 40 hrs (Constant)

I-501RG2 / RF2: Auto / 40 hrs (Constant)

*The factory-loaded battery life might be shorter than the specification.

Size: 120 X 53 X 30 mm
Weight: 65g (without battery)
Battery: 2 X AA (LR06)
Bolt: 50 mm and 80 mm

Caution:

Use only the specified type of batteries.
DO NOT use old battery with new one.
For your own safety, please do not operate the controls of the product while riding.

0.5 Watt Red LED Dynamo Carrier Light

I-501M1: Constant

I-501M2: Constant (Standlight)

*Standlight: keep the light glowing for 4 mins after you stop.

0.12 Watt Red LED Dynamo Carrier Light

I-501MG1 / MF1: Constant

Size: 120 X 53 X 24 mm
Weight: 60g
Power: Dynamo (6V AC)
Bolt: 50 mm and 80 mm

Manufactured by: Chance Good Ent. Co., Ltd.
Quality System Registered to: ISO 9001 / 14001
Website: www.infini.com.tw



A6I501R1617