

## MOUNTING YOUR LIGHT

1. Install the bracket onto your seat post, seat stay or handlebar end.
2. Slide the light into the bracket until it clicks into place.

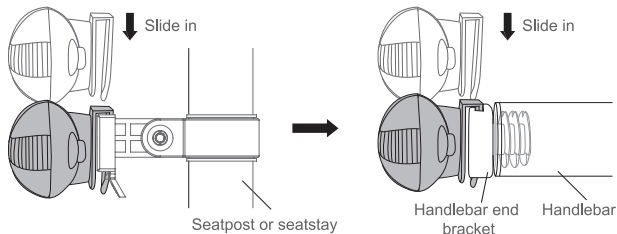

## LIGHT REMOVAL

Press the release tab and slide the light away from the bracket.

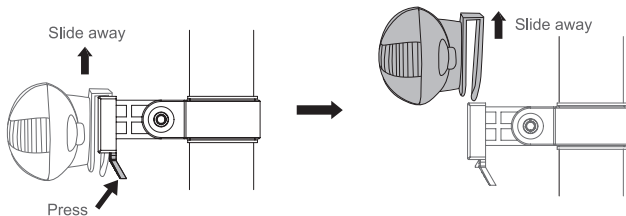

## TO SWITCH MODES

Press the button on the back of the light.

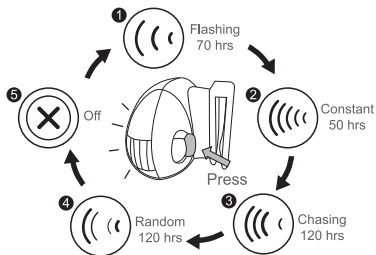

### BATTERY INSTALLATION

Turn the hanger/case in the back to right until the case opens.

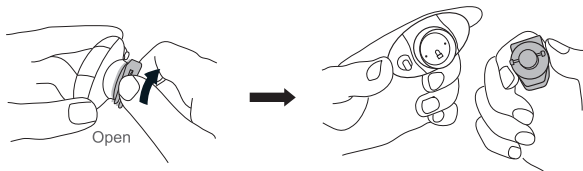

Install new 1 X CR2032 battery into main unit then put the case back and turn left to closed.

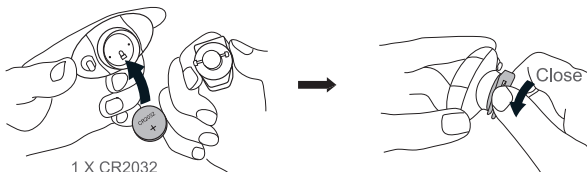

### BRACKET

RB01, Ø25mm~Ø32mm, with 2 rubber pads.

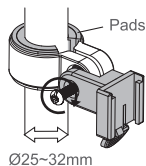

### HANDLEBAR END BRACKET

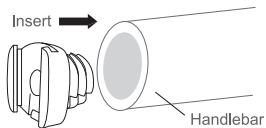

### SPECIFICATIONS

Size:	58.2 X 34.2 X 35.8 mm
Weight:	19g (without battery)
LED:	5 Red LED
Battery:	CR2032 X 1
Optional:	RC01, Ø14~Ø18 (Seatstay clamp) not included

Manufactured by: Chance Good Ent. Co., Ltd.  
Quality System Registered to: ISO 9001 / 14001  
Website: [www.infini.com.tw](http://www.infini.com.tw)



Caution:  
Use only the specified type of batteries.  
DO NOT use old battery with new one

